

SAFETY LIMIT SWITCH SLS

Features:

- Fully compatible with LINAK systems
- Sturdy, grey plastic housing
- To be mounted on the cable between the control box and the actuator
- Small dimensions for easy and inconspicuous installation
- Rated at 5A (24V DC)
- Protection class: IP 66 or IP 66 washable (all ultrasonic welded)
- Colour: grey only
- Straight cable with Jack-plug

Options:

- Available with coiled cable
- Available with DIN cable



LINAK has designed a switch that can be mounted in connection with the 24V DC actuators: LA12, LA22, LA28, LA28S, LA31, LA32 or LA34 and a control box on e.g. a bed frame.

The SLS can be a safety feature, that cuts off the current to the actuator. The SLS is available with 1 or 2 switches (activated at the same time). It can be placed to prevent an unintentional positioning of the various frame segments in relation to each other or simply as an external limit switch to protect the frame against the full thrust of the actuator in end position. The actuator stops immediately when the button is pressed.

It is necessary to specify whether the actuator is moving out or in when the switch is activated and stops the actuator.

Furthermore the SLS can be used as an external signal unit that e.g. gives a signal to a control box. This signal can limit or interrupt the functions on e.g. a bed.

SLS

Ordering example:

SLS 4 0 0 + 0 100 0 100

<p>Cable length L2 (right)</p> <p>Plug type for L2</p> <p>Cable length L1 (left)</p> <p>Plug type for L1</p> <p>Colour</p> <p>Actuator</p> <p>Function</p> <p>IP degree</p>	<p>Length in cm *</p> <p>000 = No cable (port blind plugged)</p> <p>100 = Straight, 1000 mm</p> <p>120 = Straight, 1200 mm</p> <p>150 = Straight, 1500 mm</p> <p>200 = Straight, 2000 mm</p> <p>245 = Straight, 2450 mm</p> <p>C20 = Coiled, 200 mm</p> <p>C40 = Coiled, 400 mm</p> <p>0 = No plug</p> <p>1 = Jack plug</p> <p>2 = DIN plug (4P)</p> <p>X = Other</p> <p>Length in cm *</p> <p>000 = No cable (port blind plugged)</p> <p>100 = Straight, 1000 mm</p> <p>120 = Straight, 1200 mm</p> <p>150 = Straight, 1500 mm</p> <p>200 = Straight, 2000 mm</p> <p>245 = Straight, 2450 mm</p> <p>C20 = Coiled, 200 mm</p> <p>C40 = Coiled, 400 mm</p> <p>0 = No plug</p> <p>1 = Jack plug</p> <p>2 = DIN plug (4P)</p> <p>X = Other</p> <p>+ = Grey</p> <p>- = Black (does not exist yet)</p> <p>0 = No actuator</p> <p>1=LA28</p> <p>2=LA30</p> <p>3=LA30 IP66</p> <p>4=LA31</p> <p>5=LA32</p> <p>6=LA34</p> <p>7=LA34 Compact</p> <p>0 = 1 actuator outwards direction, stops when switch is activated/ inwards direction is always possible (1*NC with diode)</p> <p>1 = 1 actuator inwards direction, stops when switch is activated/ outwards direction is always possible (1*NC with diode)</p> <p>2 = 1*NO switch external signal unit/simple switch function</p> <p>3 = 1*NC switch external signal unit/simple switch function</p> <p>X = Other</p> <p>4 = IP 66 welding</p> <p>6 = IP 66 washable welding</p>	<table border="0"> <thead> <tr> <th>Jack</th> <th>Din</th> <th>No plug</th> </tr> </thead> <tbody> <tr> <td></td> <td></td> <td></td> </tr> <tr> <td>0015705</td> <td>0015171-A</td> <td>0015034 or</td> </tr> <tr> <td>0015705</td> <td>0015171-A</td> <td>0015036 for</td> </tr> <tr> <td>0015704</td> <td>0015171-A</td> <td>LA31</td> </tr> <tr> <td>0015704</td> <td>0015171-A</td> <td></td> </tr> <tr> <td>0015704</td> <td>0015171-A</td> <td></td> </tr> <tr> <td>0015734</td> <td>0015350</td> <td></td> </tr> <tr> <td>0015736</td> <td>(does not exist)</td> <td></td> </tr> </tbody> </table> <table border="0"> <thead> <tr> <th>Jack</th> <th>Din</th> <th>No plug</th> </tr> </thead> <tbody> <tr> <td></td> <td></td> <td></td> </tr> <tr> <td>0015705</td> <td>0015171-A</td> <td>0015034 or</td> </tr> <tr> <td>0015705</td> <td>0015171-A</td> <td>0015036 for</td> </tr> <tr> <td>0015704</td> <td>0015171-A</td> <td>LA31</td> </tr> <tr> <td>0015704</td> <td>0015171-A</td> <td></td> </tr> <tr> <td>0015704</td> <td>0015171-A</td> <td></td> </tr> <tr> <td>0015734</td> <td>0015350</td> <td></td> </tr> <tr> <td>0015736</td> <td>(does not exist)</td> <td></td> </tr> </tbody> </table>	Jack	Din	No plug				0015705	0015171-A	0015034 or	0015705	0015171-A	0015036 for	0015704	0015171-A	LA31	0015704	0015171-A		0015704	0015171-A		0015734	0015350		0015736	(does not exist)		Jack	Din	No plug				0015705	0015171-A	0015034 or	0015705	0015171-A	0015036 for	0015704	0015171-A	LA31	0015704	0015171-A		0015704	0015171-A		0015734	0015350		0015736	(does not exist)	
Jack	Din	No plug																																																						
0015705	0015171-A	0015034 or																																																						
0015705	0015171-A	0015036 for																																																						
0015704	0015171-A	LA31																																																						
0015704	0015171-A																																																							
0015704	0015171-A																																																							
0015734	0015350																																																							
0015736	(does not exist)																																																							
Jack	Din	No plug																																																						
0015705	0015171-A	0015034 or																																																						
0015705	0015171-A	0015036 for																																																						
0015704	0015171-A	LA31																																																						
0015704	0015171-A																																																							
0015704	0015171-A																																																							
0015734	0015350																																																							
0015736	(does not exist)																																																							

* Also possible to order other lengths (min. Length 100mm.)
Double switch must be ordered as a special article.

Dimensions:

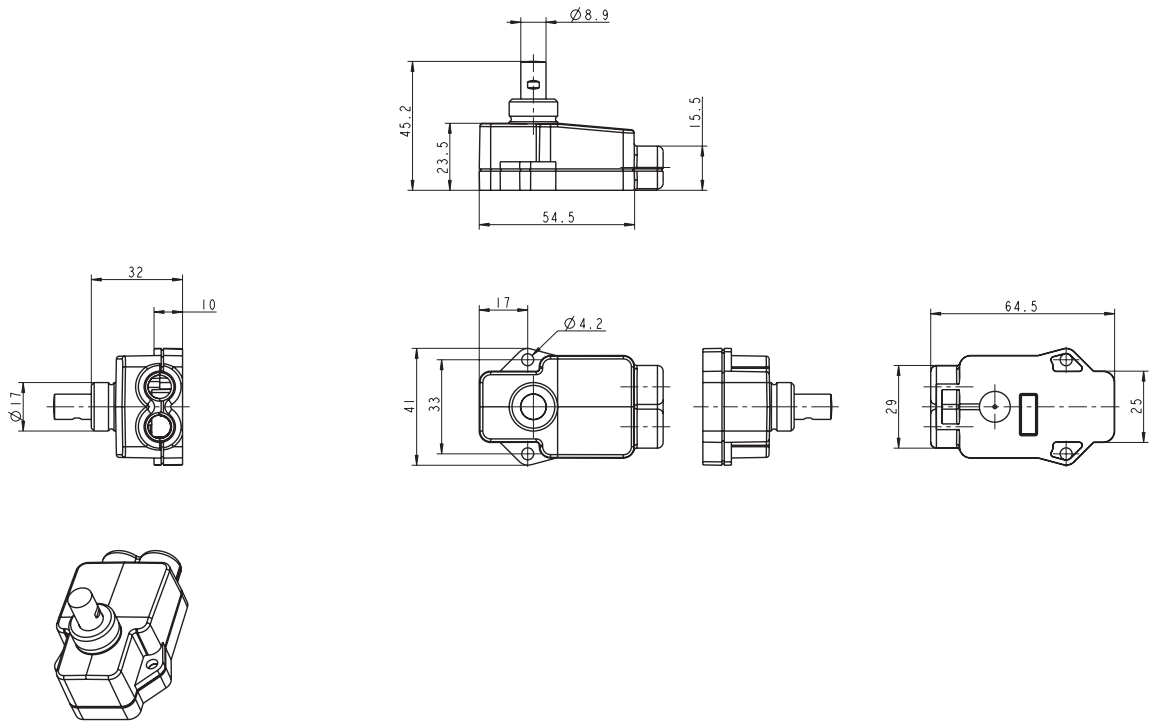

The ultrasonic welded SLS is fully compatible with the screwed SLS. All outer dimensions as well as the activation point are unchanged.

Cable length:

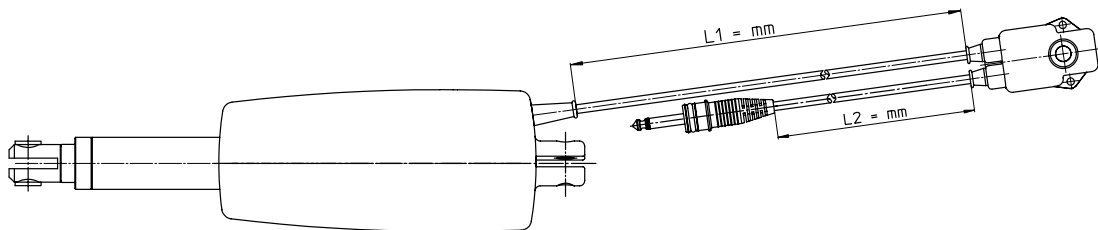

LINAK A/S
SLS002A

Specifications subject to change without prior notice.
It is the responsibility of the product user to determine the suitability of LINAK A/S products for a specific application. LINAK will at point of delivery replace/repair defective products covered by the warranty if promptly returned to the factory. No liability is assumed beyond such replacement/repair.